

## KOYO BM081210 needle roller bearings

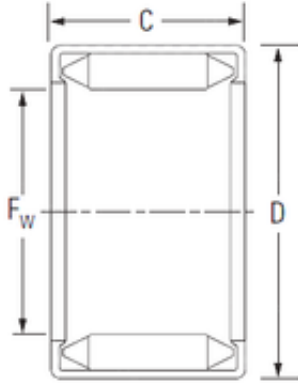

Bearing No. BM081210

Size	8x12x10 mm
Bore Diameter	8 mm
Outer Diameter	12 mm
Width	10 mm
Fw	8 mm
D	12 mm
C	10 mm
Weight	0,0037 Kg
Basic dynamic load rating (C)	4,95 kN
Basic static load rating (C0)	7,5 kN

BM081210 Bearing 2D drawings and 3D CAD models